

# REMINGTON®

## G5 Graphite Series



**PG5000**

 [www.remington.co.uk](http://www.remington.co.uk)

**Register online for an EXTRA year guarantee**

Visit [uk.remington-europe.com/product-registration](http://uk.remington-europe.com/product-registration) You must register within 28 days of purchase.

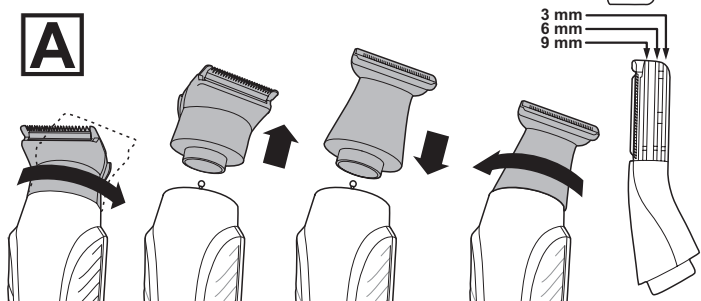
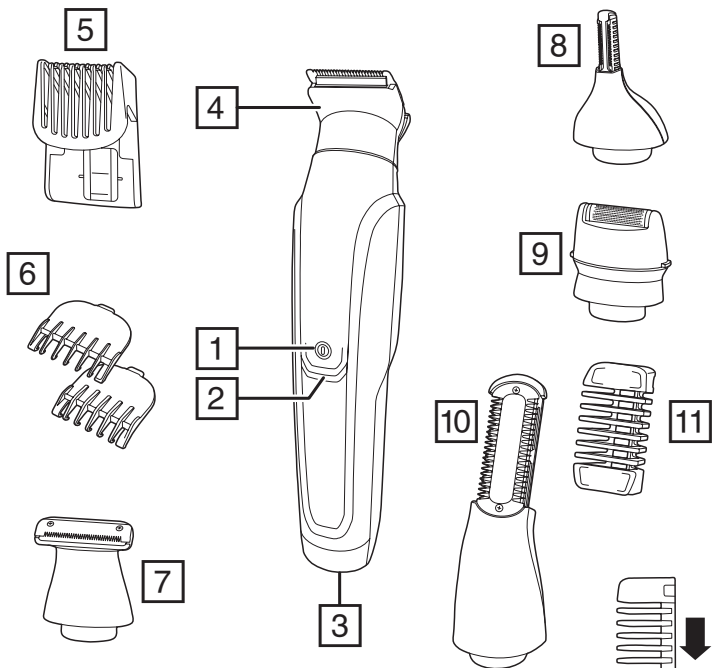

Thank you for buying your new Remington® product. Please read these instructions carefully and keep them safe. Remove all packaging before use.

---

## IMPORTANT SAFEGUARDS

---

- This appliance can be used by children aged from 8 years and above and persons with reduced physical, sensory or mental capabilities or lack of experience and knowledge if they have been supervised/instructed and understand the hazards involved. Children shall not play with the appliance. Cleaning and user maintenance shall not be done by children unless they are older than 8 and supervised. Keep the appliance and cable out of reach of children under 8 years.
- Always check the appliance before you use it. Do not use the appliance if it is damaged, as this may cause injury.
- The adaptor contains a transformer. Do not cut off the adaptor to replace it with another plug, as this causes a hazardous situation.
-  Suitable for use in a bath or shower.
- **WARNING:** Detach the shaver from the charging adaptor before cleaning it in water.
- Do not use the product with a damaged cord. A replacement can be obtained via our International Service Centres.
- **WARNING:** For recharging the battery, only use the charger supplied with the appliance - type reference PA-0505U (UK).
- Always replace a damaged adaptor with one of the original type.
- Do not use the appliance if it is damaged or malfunctions.
- This appliance should never be left unattended when plugged into a power outlet, except when charging.
- Keep the power plug and cord away from heated surfaces.
- Do not plug or unplug the appliance with wet hands.
- Do not twist or kink the cable, or wrap it round the appliance.
- This appliance is not intended for commercial or salon use.

---

## PARTS

---

1. On/Off switch
2. Charging indicator light
3. Charging connector
4. Wide trimmer
5. Adjustable comb
6. Fixed guide combs
7. Precision trimmer
8. Nose, ear, eyebrow trimmer
9. Mini foil shaver
10. Body hair trimmer
11. Body hair trimmer comb
12. Adaptor (not shown)
13. Storage pouch (not shown)

---

## CHARGING YOUR APPLIANCE

---

Before using your trimmer for the first time, charge for 4 hours.

1. Ensure the product is switched off.
2. Connect the charging adaptor to the product and then to the mains.

### CHARGING INDICATOR LIGHT

Charge Level	Indicator
Charging	Blue LED will flash
Fully Charged	Blue LED will light up continuously
Battery charge is low	Red LED will flash

- Your trimmer cannot be overcharged. However, if it is not going to be used for an extended period of time (2-3 months), unplug it from the mains and store.
- To preserve the life of your batteries, let them run out every 6 months then recharge for 4 hours.
- On a full charge, your beard trimmer will run for up to 90 minutes of cordless usage.

---

## ATTACHMENTS

---

### TO FIT AND REMOVE ATTACHMENTS (FIG. A)

Ensure that the device is switched off before fitting or removing attachments.

- To remove, rotate the attachment anti-clockwise until it unlocks and then lift it off.
- To fit, place the desired attachment on top of the device and rotate the attachment clockwise to lock it into place.

## FITTING AND REMOVING FIXED GUIDE COMBS

### To Fit

- Hook the front of the guide comb over the teeth of the wide trimmer.
- Press the back of the guide comb down until it clicks into place.

### To Remove

- Lift the tab on the back of the guide comb upwards until it comes free from the wide trimmer head.

## FITTING AND REMOVING THE ADJUSTABLE COMB

- To fit, line up the rails on the comb with the slots on the sides of the groomer and slide the comb downwards onto the groomer.
- To adjust, press and hold the adjustment button on the back of the comb and slide the comb up or down. Release the button to lock the comb at that position. The length of cut is indicated by the scale on the side of the trimmer.
- To remove, press and hold the adjustment button and push the comb up and off the groomer.

---

## INSTRUCTIONS FOR USE

---

- Comb facial hair with a fine comb before you start trimming.
- Comb your hair in the direction that it grows so that the hairs are at their maximum height and facing in the same direction.
- After trimming, lightly go over the trimmed areas with the foil to get a smooth clean finish.
- Since all hairs do not grow in the same direction, you may want to try different trimming positions (i.e. upwards, downwards or across) for better results.
- Hair should be dry and free from any waxes or lotions.
- If hair builds up during use, switch the unit off, remove any attachment in use and clean any excess hair clippings from the attachment and groomer.

## 3-DAY STUBBLE, AND BODY HAIR MAINTENANCE

<b>Attachments</b>
Wide trimmer with 1.5 mm fixed comb
Body hair attachment

### **3-day stubble look:**

Let your stubble grow to a length that is slightly longer than the look you are trying to achieve.

1. Fit the 1.5 mm fixed comb to the wide trimmer attachment.
2. Run your trimmer through your beard against the direction of hair growth.

3. Tidy the edges of the stubble using the precision trimmer attachment.
- For more control over the length of your stubble, you can use the adjustable comb and trim your stubble down in increments starting at a longer length setting until you get the desired look.

#### **Body hair maintenance: Trimming to length**

1. Fit the body hair attachment.
2. Body hair can be trimmed to 3 different lengths (3, 6 and 9 mm). Select the desired length by sliding the comb into one of the three slots on the side of the attachment.
3. Place the flat side of the attachment against the skin.
4. Slowly slide the trimmer through the hair in the direction of hair growth.
5. Use slow, well-controlled movements.

#### **Body hair maintenance: Removal**

1. Remove the comb from the body hair attachment and go over the areas where you want to remove the body hair.
2. Stretch the skin with your free hand to make the hairs stand upright.
3. Use light pressure and shave against the direction of hair growth.

## **HAIR CLIPPING**

<b>Attachments</b>
Wide trimmer with adjustable comb

#### **Step 1: Nape of the neck**

1. Fit the wide trimmer and adjustable comb.
2. Set the adjustable comb to 4 mm or 6 mm.
3. Hold the clipper with the blade teeth pointing upwards. Begin starting at the centre of the head at the base of the neck.
4. Slowly lift the clipper, working upwards and outwards through the hair, trimming just a little at a time.

#### **Step 2: Back of the head**

- With the comb set at 12 mm or 18 mm, cut the hair at the back of the head.

#### **Step 3: Side of the head**

1. Adjust the comb to a shorter length setting for the areas around the ears.
2. Increase the length setting on the adjustable comb to gradually transition the length of hair on the side of the head to the longer hair on the top of the head.

#### **Step 4: Top of the head**

1. Adjust the comb to the longer length settings (up to 20 mm) then cut the hair on top of the head against the direction in which the hair normally grows.
2. Always work from the back of the head.

### **Trim the sideburns**

- To trim the sideburns, adjust the comb to the desired length setting, or use one of the fixed guide combs.

### **SHORT/LONG BEARD TRIMMING**

<b>Attachments</b>
Wide trimmer with adjustable comb
Precision trimmer

1. Fit the wide trimmer and adjustable comb.
2. Set the adjustable comb to the desired length.
3. Start trimming under the chin following the line of the jaw.
4. Work upwards towards the ear and upper beard line.
5. Tidy the beard edges using the precision trimmer attachment.

### **CONTOUR EDGING AND CLOSE HAIR CUTTING**

<b>Attachments</b>
Wide trimmer

#### **Contour edging:**

1. Hold the device with the cutting blade (teeth) facing you and at 90 degrees to the skin.
2. Start with the edge of the beard/moustache line and, with the blade resting lightly against the skin, use slow controlled movements to create contoured lines.

#### **Close hair cutting:**

1. Use the fingers of one hand to lift the hair at the base of your head up off your neck.
2. Your index finger should be covering the roots of the hairs you are lifting to prevent them from being accidentally cut.
3. Hold the trimmer to the base of your neck with the blade facing up. Move the trimmer up the neck until it touches your index finger which is protecting the hair roots.
4. Move your trimmer slowly and keep the hair roots at the base of your head out of the way of the trimmer.

### **DETAILED NOSE, EYEBROW AND EAR HAIR TRIMMING**

<b>Attachments</b>
Nose, ear and eyebrow trimmer

#### **Nose and ear:**

1. Fit the nose, ear and eyebrow trimmer.

2. Insert the attachment gently into the nostril or ear.
3. Gently move the attachment in and out while rotating the body of the groomer at the same time.
  - Don't insert the attachment more than 6 mm.
  - Wash the attachment after each use.

***Eyebrow:***

1. Carefully guide the attachment to remove any stray or longer hairs from the eyebrow.
2. To completely remove hairs, let the attachment touch the skin then move over the desired area.

**MICRO STUBBLE AND PRECISION TRIMMING**

<b><i>Attachments</i></b>
Precision trimmer

***Micro stubble:***

The precision trimmer attachment has Trim Shave Technology which trims hair down to 0.2 mm to leave a micro stubble finish.

1. Fit the precision trimmer.
2. Hold the attachment so that the guide on the lower edge of the blade contacts the skin (the same way you would hold a wet razor). The guide on the lower edge of the blade helps to stretch the skin during trimming.
3. Use motions similar to wet shaving.

***Precision trimming:***

1. Hold the precision trimmer attachment perpendicular to the skin.
2. Move it towards or away from the beard hair to achieve the desired result. Use gentle pressure and controlled movements.

**CLEAN SHAVEN EDGING**

<b><i>Attachments</i></b>
Mini Foil Shaver

1. Hold the trimmer so the mini foil shaver gently touches your face.
2. Use short, well-controlled movements to shave around your beard moustache. Use your free hand to stretch your skin. This encourages the hair to stand upright, making it easier to shave.
  - Note: The mini foil shaver was designed to shave the detail areas around your beard/moustache/sideburns. It was not designed to shave your entire face. For a close comfortable shave, guaranteed, use one of Remington's electric shavers.



---

## CARE FOR YOUR GROOMER

---

Care for your product to ensure a long lasting performance. We recommend that you clean your groomer after each use.

### AFTER EACH USE

- Brush any accumulated hairs from the groomer and attachment heads.
- The easiest and most hygienic way to clean the groomer is by detaching the head from the groomer body and rinsing the head with warm water.
- The groomer body should not be rinsed.
- Place one or two drops of cutter oil or sewing machine oil on the blades.
- Turn the clipper on to distribute the oil evenly, wipe off any excess oil.

---

## BATTERY REMOVAL

---

We strongly recommend that a professional removes the rechargeable battery. Parts of the shaver case, and tools have sharp edges and may cause injury if not handled correctly.

- The rechargeable battery must be removed from the appliance before it is scrapped.
  - Disconnect the charging adapter before removing the battery.
1. Ensure the device is discharged of all power. To do this, switch it on and allow it to run until it stops.
  2. Using a suitable tool, carefully pry apart the front and rear halves of the case at the joint line.
  3. Remove the two screws that hold the transparent inner case to the back half of the outer case.
  4. Lift out the inner case.
  5. Pull the black motor holder off the transparent case.
  6. Slide the circuit board and battery out of the transparent inner case.
  7. Cut the tabs holding the battery to the circuit board.
- Used batteries must be removed from the appliance and disposed of at an appropriate official recycling/collection point.
  - Do not attempt to operate the shaver once you have opened it.

---

## RECYCLING

---



To avoid environmental and health problems due to hazardous substances, appliances and rechargeable and non-rechargeable batteries marked with one of these symbols must not be disposed of with unsorted municipal waste. Always dispose of electrical and electronic products and, where applicable, rechargeable and non-rechargeable batteries, at an appropriate official recycling/collection point.

---

## SERVICE AND GUARANTEE

---



Defects affecting product functionality appearing within the guarantee period will be corrected by replacement or repair at our option provided the product is used and maintained in accordance with the instructions. Your statutory rights are not affected.

To claim an extra 1 year guarantee, register your product online within 28 days of purchase.

Register at: <https://uk.remington-europe.com/product-registration>

Consumables are guaranteed only for their recommended lifecycle. Replacement/spare parts\* are excluded and are only covered by a 1 year warranty.

\*Examples include, but are not limited to, adaptors, haircare attachments, grooming accessories, etc.

---

## SERVICE CENTRE

---

### UNITED KINGDOM

 0800 212 438 (free call mainland UK)

Spectrum Brands (UK) Ltd  
Fir Street, Failsworth, Manchester  
M35 0HS, UK

[www.remington.co.uk](http://www.remington.co.uk)

### IRELAND

 142 951 40

Remington Consumer Products,  
Unit B12, Ballymount Corporate Park,  
Ballymount, Dublin 12

<https://ie.remington-europe.com>

**Ref. No. PG5000**

**Type No. PG05A**

19/UK/ PG5000 T22-7000785 Version 06 /19

Remington® is a Registered Trade Mark of Spectrum Brands, Inc., or one of its subsidiaries.

Spectrum Brands (UK) Ltd

Fir Street,

Failsworth,

Manchester

M35 0HS

[www.remington.co.uk](http://www.remington.co.uk)

© 2019 Spectrum Brands, Inc.